

Trouble Shooting

Water is leaking around the bottom of the trough:

The most likely cause is that you did not push the pipe through the seal. Sometimes it is quite hard to push pipe through the seal, particularly at the angles required with our trough. You may want to keep measuring the pipe you are plugging into the fitting. Some silicon and chamfering the end of the pipe may also help for you to get through the seal if you are having difficulty.

Trough is overflowing:

1) Take the float out of the trough centre by pushing down and pulling out (the reverse action of installation). Tip all of the water out. Is water still coming in?

Yes → Problem: Valve leaking or Tee not tight enough

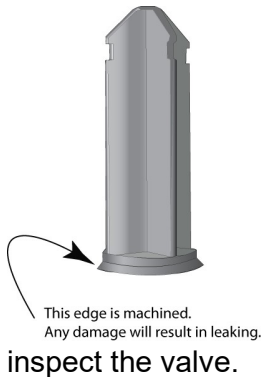

Then either the valve is damaged or the tee is not screwed into the trough firmly enough. Push the valve up and down a couple of times to see if you can dislodge anything that is stuck between the plunger seat and the valve body. If this doesn't remedy the problem, take the pipe out of the trough tee (push pipe in, turn a ¼ turn anticlockwise, pull). Undo the tee (noting the firmness of the fit) and visually

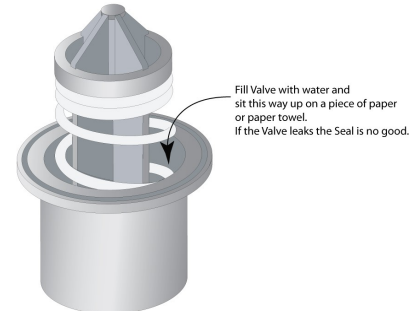

No → Problem: Float arm

Not enough free play at the top of the stroke (clearance between arm and valve head).

OR

If parts aren't correct you can get a "reverse lever problem", i.e., when trough overfills for whatever reason (e.g. rain) the arm starts to lever on its back edge.

This could be due to production, plastic wearing out or an animal bending the float arm (very hard to do but has accounted for some cases)

You will notice the trough fills and then seems to stop momentarily and continues. It has gone past the first fulcrum point and is now levering against the back of the trough centre. The fix could be: bending the float arm (use a vise).

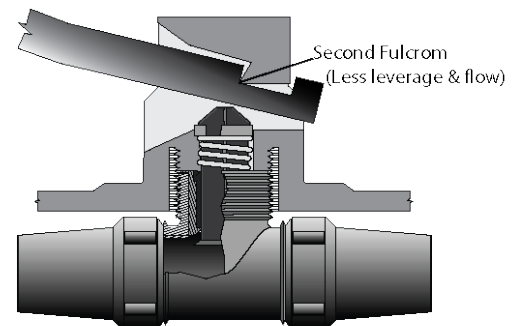
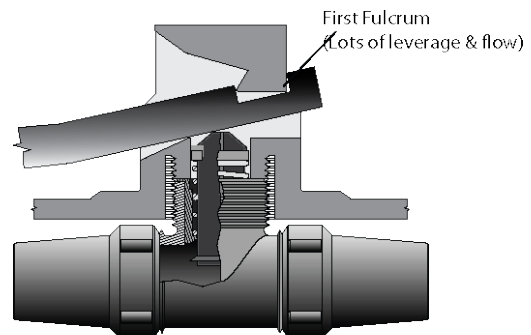

If Water continues to leak out of trough even though the trough is full:

